

BioAktiv for Plants,  
use in organic farming over 4 years with 4-fold repetition of potatoes.

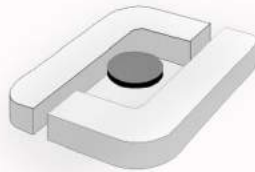

## Osnabrück College

Hochschule Osnabrück - Postfach 1940 - D-49009 Osnabrück

### **BioAktiv GmbH**

Herr Krumbholz

Bockwitzer Str. 80

**06712 Zeitz OT Würchwitz**

### **Dept. of Agricultural Economics and Landscaping (F A&L)**

Agricultural degree program

Dipl.agr.oec. U. Schliephake

Location, parcel address:  
Am Krümpel 31  
D-49090 Osnabrück

Phone (0541) 969-5057

Fax 969-5060

Email [u.schliephake@hs-osnabrueck.de](mailto:u.schliephake@hs-osnabrueck.de)

---

Your ref./message

My ref.

Osnabrück  
Feb. 18, 2015

---

## Use of BioAktiv and comparison of application rates

Experimental year: 2014  
Crop: Potatoes  
Establishment: "BIOLAND" experimental farm, Waldhof college  
Plot: An der Hecke  
Variety: Anuschka

~114 plants/plot      8 m long, 3 m wide, planted at intervals of  
fully randomized Latin square  
4 replicates  
Core harvesting (ca. 57 plants)

Planted: March 20, 2014  
Harvested: June 26, 2014

Versions:

1	control	
2	BioAktiv 1 kg*	VA <sup>1)</sup>
3	BioAktiv 1 kg + BioAktiv 0.5 kg*	VA + NA <sup>2)</sup>
4	BioAktiv 2 kg*	VA

\* 1kg BioAktiv dissolved in 330 l fresh water

1) before emergence  
2) after emergence

Treatments:

April 3, 2014    BioAktiv VA versions (1 or 2 kg)  
May 6, 2014    BioAktiv NA version (0.5 kg)

Soil: sandy loam to loamy sand, 38 ground points  
Preceding crop: Trefoil-grass  
Pre-preceding crop: Trefoil-grass

Rep4	4	3	2	1
Rep3	3	1	4	2
Rep2	2	4	1	3
Rep1	1	2	3	4

Harvested: Plot 8x1.5= 12m<sup>2</sup>  
750ml /plot

Results 2014:

	<30 mm	30-60 mm	>60 mm	Discarded*	Market grade**	Total yield
<b>2014 dt/ha</b>						
Control	10.9	239.8	7.3	239.8	257.9	
BioAktiv 1kg	14.9	233.7	6.0	233.7	254.6	
BioAktiv 1 kg + 0.5 kg	12,7	252.0	11.8	252.0	276.5	
BioAktiv 2kg	12.1	274.3	5.4	274.3	291.8	
least significant difference 5%						
Sign.level	n.s. <sup>3)</sup>	n.s.	n.s.	n.s.	n.s.	

3) not significant

\* green, damaged, wireworm, drycore, growth cracks \*\* Sum of 30-60 mm + >60 mm

Multiannual results:

	<30 mm	30-60 mm	>60 mm	Discarded*	Market grade**	Total yield
<b>4 years</b>						
Control	9.7	194.2	21.0	31.5	215.2	256.4
BioAktiv 1 kg	12.0	217.9	20.3	39.6	238.2	289.8
BioAktiv 1 kg + 0.5 kg	8,5	192.3	37.6	49.1	229.9	287.5
BioAktiv 2kg	9.8	219.5	26.2	35.3	245.7	290.8
least significant difference 5% Tukey						
Sign.level	n.s.	n.s.	n.s.	n.s.	n.s.	n.s.

\* green, damaged, wireworm, drycore, growth cracks \*\* Sum of 30-60 mm + >60 mm

A multi-year trial was run to establish the extent to which different amounts of BioAktiv would produce higher yields.

The quantities used were 1 kg, 2 kg and 1+0.5 kg. Full kg were sprayed before emergence, 0.5 kg when the plants were approx. 10 cm high.

It was found that each of the quantities sprayed tended to produce higher yields (over several years) than the untreated plants.

Multiannual	Yield, market grade	Total yield
Control	100	100
<b>BioAktiv 1 kg</b>	<b>111</b>	<b>113</b>
BioAktiv 1 kg + 0.5 kg	107	112
BioAktiv 2 kg	114	113

Yours sincerely